

IRRIGATION SCHEDULE

| SYMBOL | MANUFACTURER/MODEL/DESCRIPTION | QTY |
|--------|---|------------|
| | Rain Bird 1806 15 Strip Series Turf Spray 6.0in. Pop-Up Sprinkler with Co-Molded Wiper Seal. Side and Bottom Inlet. 1/2in. NPT Female Threaded Inlet. | 17 |
| | Rain Bird 1806 ADJ Turf Spray 6.0in. Pop-Up Sprinkler with Co-Molded Wiper Seal. Side and Bottom Inlet. 1/2in. NPT Female Threaded Inlet. | 28 |
| | Rain Bird 1812 SQ Series Shrub Spray 12in. Pop-Up Sprinkler with Co-Molded Wiper Seal. Side and Bottom Inlet. 1/2in. NPT Female Threaded Inlet. | 2 |
| | Rain Bird 1812 15 Strip Series Shrub Spray 12in. Pop-Up Sprinkler with Co-Molded Wiper Seal. Side and Bottom Inlet. 1/2in. NPT Female Threaded Inlet. | 71 |
| | Rain Bird 1812 ADJ Shrub Spray 12in. Pop-Up Sprinkler with Co-Molded Wiper Seal. Side and Bottom Inlet. 1/2in. NPT Female Threaded Inlet. | 21 |
| | Rain Bird 1806-1300AF Flood Flood Bubbler 6.0in. pop-up, with a PA-80 adapter. | 84 |
| SYMBOL | MANUFACTURER/MODEL/DESCRIPTION | QTY |
| | Rain Bird PEB 1in., 1-1/2in., 2in. Plastic Industrial Valves. Low Flow Operating Capability, Globe Configuration. | 13 |
| | Feeco 825Y 1" Reduced Pressure Backflow Preventer | 1 |
| | Rain Bird ESPLXME2 12 Station Traditionally-Wired, Commercial Controller. Indoor/Outdoor, Plastic Wall-Mount Enclosure. | 1 |
| | Rain Bird RSD-BEX Rain Sensor, with metal latching bracket, extension wire. | 1 |
| | Water Meter 1" | 1 |
| | Irrigation Lateral Line: PVC Schedule 40 Minimum 3/4" in size | 2,629 l.f. |
| | Irrigation Mainline: PVC Schedule 40 2 1/2" Gasketed, run with 2" Grey PVC electrical conduit | 496 l.f. |
| | Pipe Sleeve: PVC Schedule 40 Size per sleeve chart | 352 l.f. |

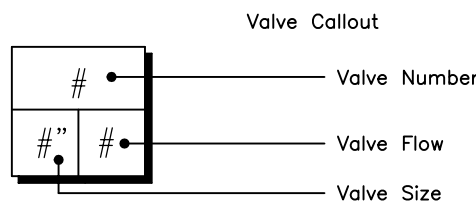

VALVE SCHEDULE

| NUMBER | MODEL | SIZE | TYPE | GPM |
|--------|---------------|--------|-------------|-------|
| 1 | Rain Bird PEB | 1-1/2" | Turf Spray | 8.14 |
| 2 | Rain Bird PEB | 1-1/2" | Bubbler | 23.8 |
| 3 | Rain Bird PEB | 1-1/2" | Shrub Spray | 25.45 |
| 4 | Rain Bird PEB | 1-1/2" | Bubbler | 23.8 |
| 5 | Rain Bird PEB | 1-1/2" | Shrub Spray | 24.26 |
| 6 | Rain Bird PEB | 1-1/2" | Turf Spray | 28.28 |
| 7 | Rain Bird PEB | 1-1/2" | Bubbler | 22.1 |
| 8 | Rain Bird PEB | 1-1/2" | Bubbler | 25.5 |
| 9 | Rain Bird PEB | 1-1/2" | Shrub Spray | 22.79 |
| 10 | Rain Bird PEB | 1-1/2" | Bubbler | 22.1 |
| 11 | Rain Bird PEB | 1-1/2" | Turf Spray | 17.45 |
| 12 | Rain Bird PEB | 1-1/2" | Bubbler | 32.3 |
| 13 | Rain Bird PEB | 1-1/2" | Shrub Spray | 27.1 |

| SLEEVE CHART | |
|--------------|-------------|
| PIPE SIZE | SLEEVE SIZE |
| 3/4" | 2 1/2" |
| 1" | 3" |
| 1 1/4" | 3" |
| 1 1/2" | 4" |
| 2" | 4" |
| 2 1/2" | 6" |
| 3" | 6" |
| 4" | 8" |
| 6" | 10" |
| 8" | 12" |

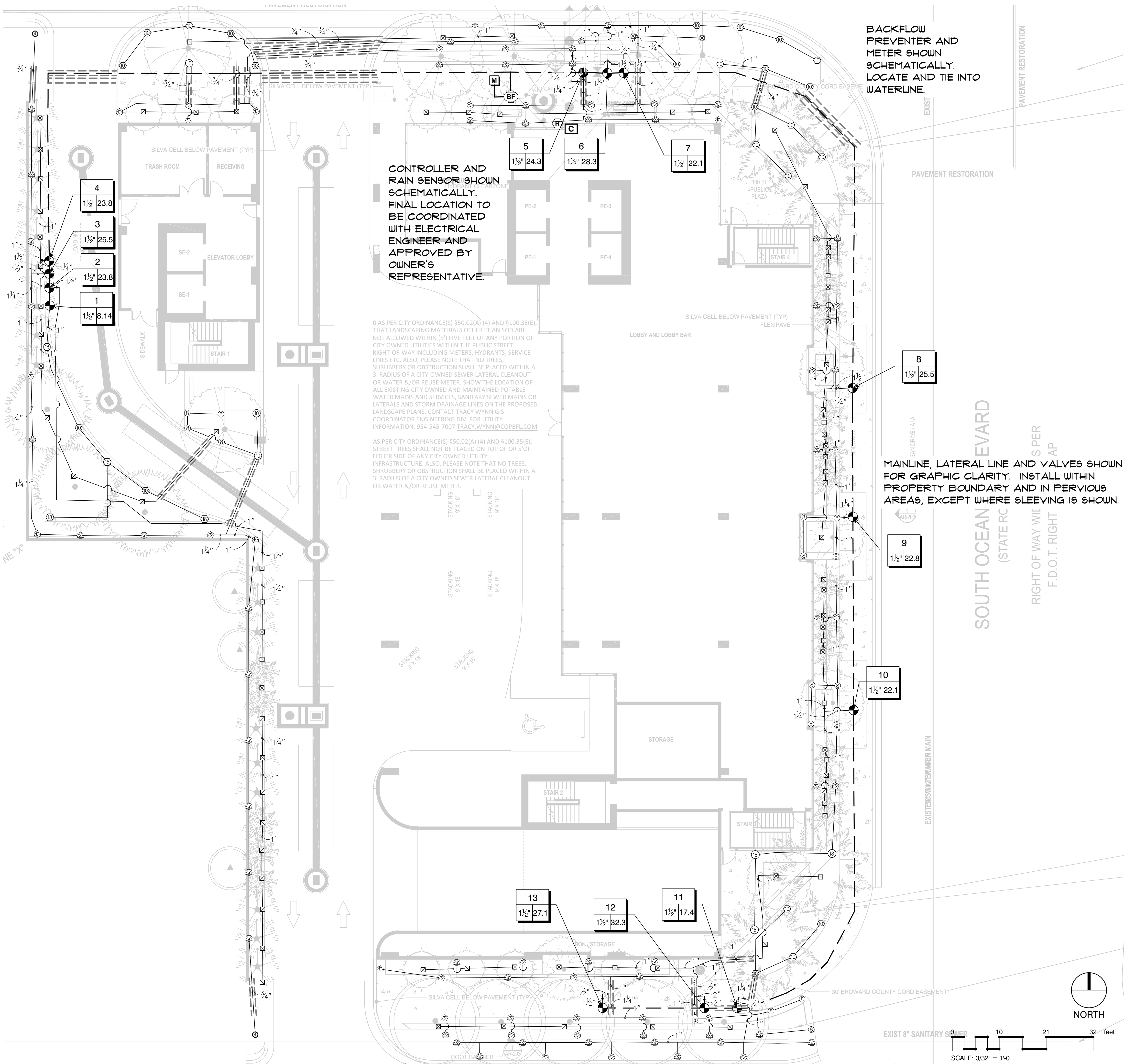

BACKFLOW
PREVENTER AND
METER SHOWN
SCHEMATICALLY.
LOCATE AND TIE INTO
WATERLINE.

CONTROLLER AND
RAIN SENSOR SHOWN
SCHEMATICALLY.
FINAL LOCATION TO
BE COORDINATED
WITH ELECTRICAL
ENGINEER AND
APPROVED BY
OWNER'S
REPRESENTATIVE.

0 AS PER CITY ORDINANCE(S) §50.02(A) (4) AND §100.35(E),
THAT LANDSCAPING MATERIALS OTHER THAN SOD ARE
NOT ALLOWED WITHIN (5') FIVE FEET OF ANY PORTION OF
CITY OWNED UTILITIES WITHIN THE PUBLIC STREET
RIGHT-OF-WAY INCLUDING METERS, HYDRANTS, SERVICE
LINES ETC. ALSO, PLEASE NOTE THAT NO TREES,
SHRUBBERY OR OBSTRUCTION SHALL BE PLACED WITHIN A
3' RADIUS OF A CITY-OWNED SEWER LATERAL CLEANOUT
OR WATER &/OR REUSE METER. SHOW THE LOCATION OF
ALL EXISTING CITY OWNED AND MAINTAINED POTABLE
WATER MAINS AND SERVICES, SANITARY SEWER MAINS OR
LATERALS AND STORM DRAINAGE LINES ON THE PROPOSED
LANDSCAPE PLANS. CONTACT TRACY WYNN GIS
COORDINATOR ENGINEERING DIV. FOR UTILITY
INFORMATION. 954-545-7007 TRACY.WYNN@COPBFL.COM

AS PER CITY ORDINANCE(S) §50.02(A) (4) AND §100.35(E),
STREET TREES SHALL NOT BE PLACED ON TOP OF OR 5' OF
EITHER SIDE OF ANY CITY OWNED UTILITY
INFRASTRUCTURE. ALSO, PLEASE NOTE THAT NO TREES,
SHRUBBERY OR OBSTRUCTION SHALL BE PLACED WITHIN A
3' RADIUS OF A CITY OWNED SEWER LATERAL CLEANOUT
OR WATER &/OR REUSE METER.

MAINLINE, LATERAL LINE AND VALVES SHOWN
FOR GRAPHIC CLARITY. INSTALL WITHIN
PROPERTY BOUNDARY AND IN PERVIOUS
AREAS, EXCEPT WHERE SLEEVING IS SHOWN.

FSM
ARCHITECTS + PLANNER

888 SOUTH ANDREWS AVE. SUITE 300
FORT LAUDERDALE, FLORIDA 33316
PH: (954) 764-6575 FAX: (954) 764-8622

JEFF FALKANGER, DOUG SNYDER
LARRY MARTINEAU, JIRO YATES

COPYRIGHT 2021

FALKANGER, SNYDER, MARTINEAU, & YATES ALL RIGHTS
RESERVED. THIS DOCUMENT OR PARTS THEREOF MAY NOT
BE REPRODUCED IN ANY FORM WITHOUT PERMISSION

CA # AAC000447



888 S. Andrews Avenue, Suite 300
Fort Lauderdale, FL 33316
Office: 954.224.0432
LA# 6666983

| | | |
|----------|--------|---------|
| DESIGNED | DRAWN | CHECKED |
| Designer | Author | Checker |

REVISIONS

Natalia Barranco
c=US, st=Florida, l=Fort lauderdale,
o=Barranco rla inc., cn=Natalia
Barranco, email=natalia@b-rla.com
2023.12.18 19:37:26 -05'00'

| | |
|------------|----------------|
| DATE: | COMM: |
| Issue Date | Project Number |

POMPAÑO HOTEL

101 S. OCEAN BLVD
POMPAÑO BEACH, FL 33062

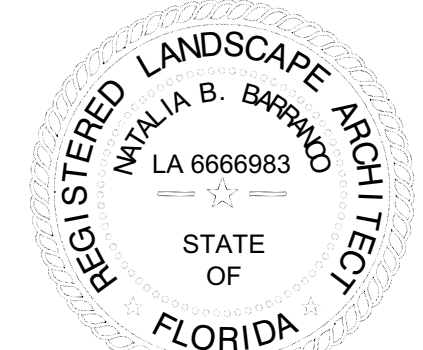

IRRIGATION PLAN

DRC SET

IR-1.0

DRC
PZ23-12000042
02/07/2024